

WX16S Series

1.6 x 1.0mm Watch crystal



RoHS & REACH compliant
Vacuum sealed miniature ceramic package for excellent stability
Low power consumption
Suitable for UAVs and Drones



Parameters		Specification	Remarks
Frequency	F_nom	32.768kHz	
Frequency tolerance	F_tol	±20ppm	
Operating temperature range	T_use	-20°C ~ +70°C	
Operable temperature range	T_opr	-40°C ~ +85°C	
Temperature coefficient	K	-0.045ppm/°C² Max	
Turnover temperature	Ti	25°C ± 5°C	
Load capacitance	CL	12.5pF	Please enquire for other values
Equivalent series resistance	ESR	90KΩ max	
Shunt capacitance	C0	2.0pF max	
Drive level	DL	0.1μW typical, 0.5μW max	

Dimensions (mm)

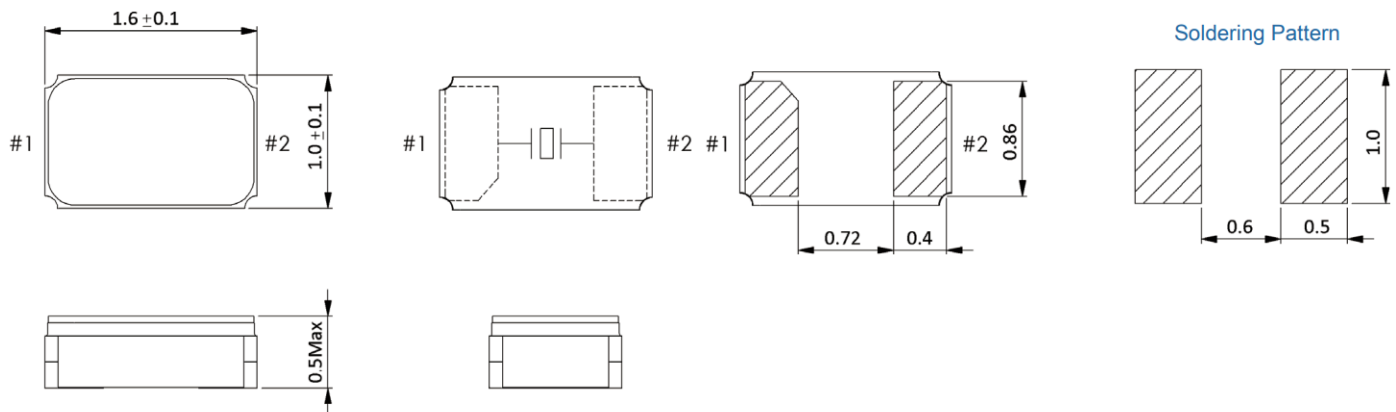

Part number generation						
WXS	00003	G	D	H	H	-PF
ACT Series Code	Frequency (KHz)	Frequency Tolerance (±ppm)	Operating Temperature Range (°C)	Load capacitance (CL)	Packaging (Tape & Reel)	RoHS
WXS	32.768kHz = 00003	±20 = G	-20 ~ +70 = D	12.5pF = H	Loose/Sample = L 5000pcs = H	RoHS = -pF

Note: It is important to suffix the above part number with full frequency required to give a completed part number as illustrated below.
Full Example Part Number : **WXS00003GDHH-PF (32.768kHz)**

WX16S Series

1.6 x 1.0mm Watch crystal



Reflow profile

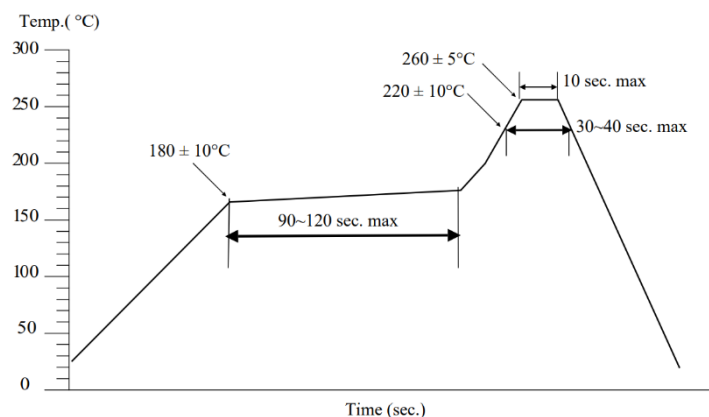

Drawing control: (Internal use only)
Commodity code: 854 160 00 00
Issue number: N1
Date: 03/12/2025
Internal reference: H3